

ශ්‍රී ලංකා ප්‍රජාතාන්ත්‍රික සමාජවාදී ජනරජයේ ගැසට් පත්‍රය

අති විශේෂ

The Gazette of the Democratic Socialist Republic of Sri Lanka  
EXTRAORDINARY

අංක 1958/25 - 2016 මාර්තු මස 17 වැනි බ්‍රහස්පතින්දා - 2016.03.17

No. 1958/25 - THURSDAY MARCH 17, 2016

(Published by Authority)

**PART I : SECTION (I) — GENERAL**

**Government Notifications**

**CEYLON ELECTRICITY BOARD ACT, NO. 17 OF 1969**

**Order under Section 57**

BY virtue of the powers vested in me by Section 57 of Ceylon Electricity Board Act, No. 17 of 1969, I, Ranjith Siyambalapitiya, Minister of Power and Renewable Energy, do by this order, approve the proposed acquisition of lands required by the Ceylon Electricity Board and described in the Schedule hereto.

RANJITH SIYAMBALAPITIYA,  
Minister of Power and Renewable Energy.

16 th March 2016 .



The lands situated in the village of Kalukohuthenna in Grama Niladari's Division of No. 134 D, Kalukohuthenna in the Divisional Secretary's Division of Yatiyantota at Dehigampala Korale, in the Administrative District of Kegalle in the Province of Sabaragamuwa of Sri Lanka containing in extents of 0.1265 (50 Perches) Hectares shown in Draft Plan No. BHP 001 dated 26.02.2016, depicted as Block No. 01 and 0.5691 (1 Acre, 1 Rood and 25 Perches) Hectares shown in Draft Plan No. BHP 002 dated 26.02.2016, depicted as Block No. 02 prepared by Ceylon Electricity Board and bounded as follows :

01. Block No. 01 - Land in extent of 0.1265 Hectares (50 Perches) with permanent building
  - North : Avissawella - Hatton main road ;
  - East : Not relevant ;
  - South : Road to Pokunawala village ;
  - West : Not relevant.
  - Claimed by : unknown.
  
02. Block No. 02 - Land in extent of 0.5691 Hectares (1 Acre, 1 Rood and 25 Perches)
  - North : Gamsabha Road;
  - East : Kelani River ;
  - South : Kelani River ;
  - West : Gamsabha Road
  - Claimed by : unknown.

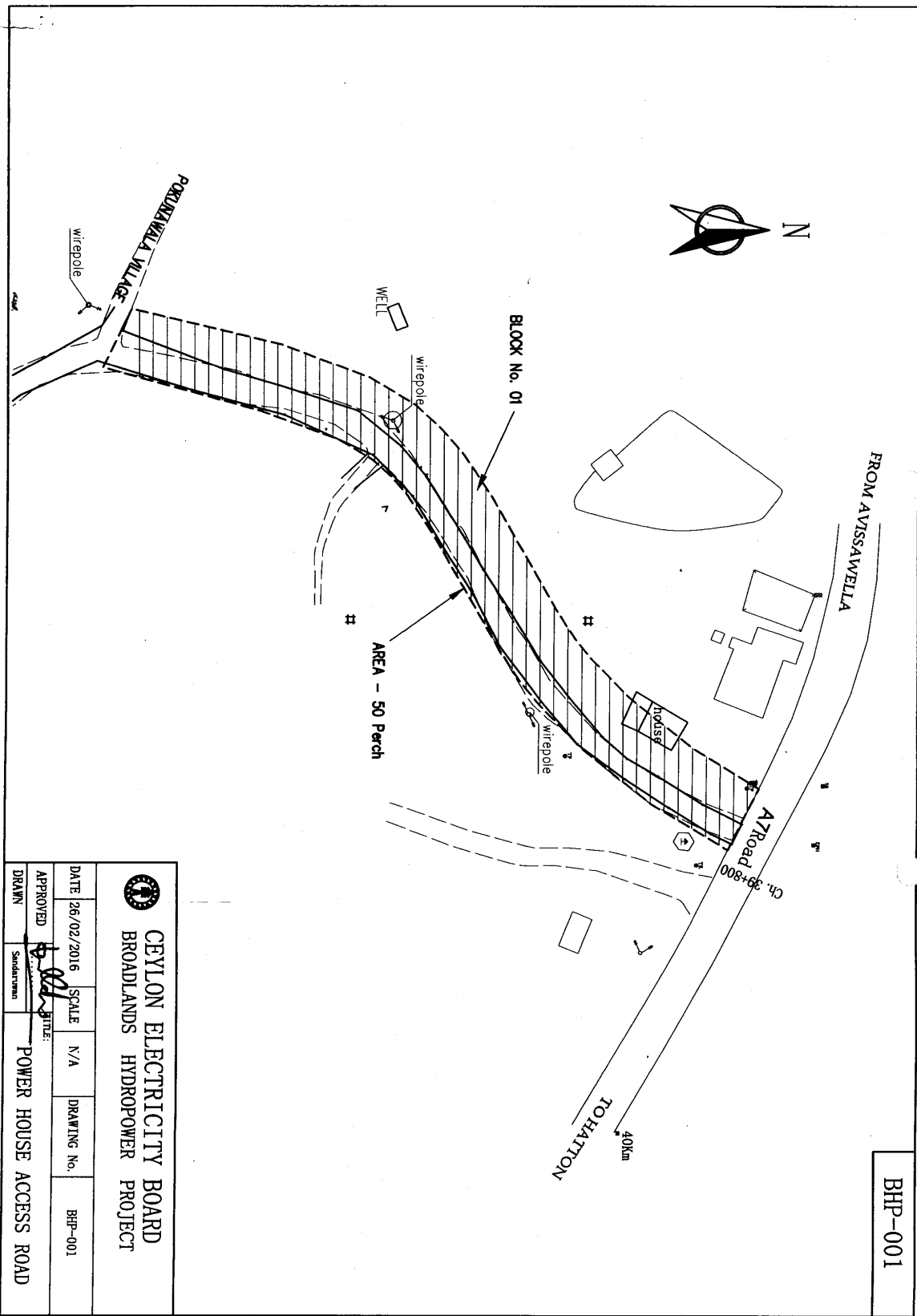

2A



 <b>CEYLON ELECTRICITY BOARD</b> <b>BROADLANDS HYDROPOWER PROJECT</b>			
DATE	26/02/2016	SCALE	N/A
DRAWING No.		BHP-001	
APPROVED	 Sanderwan		
DRAWN	POWER HOUSE ACCESS ROAD		

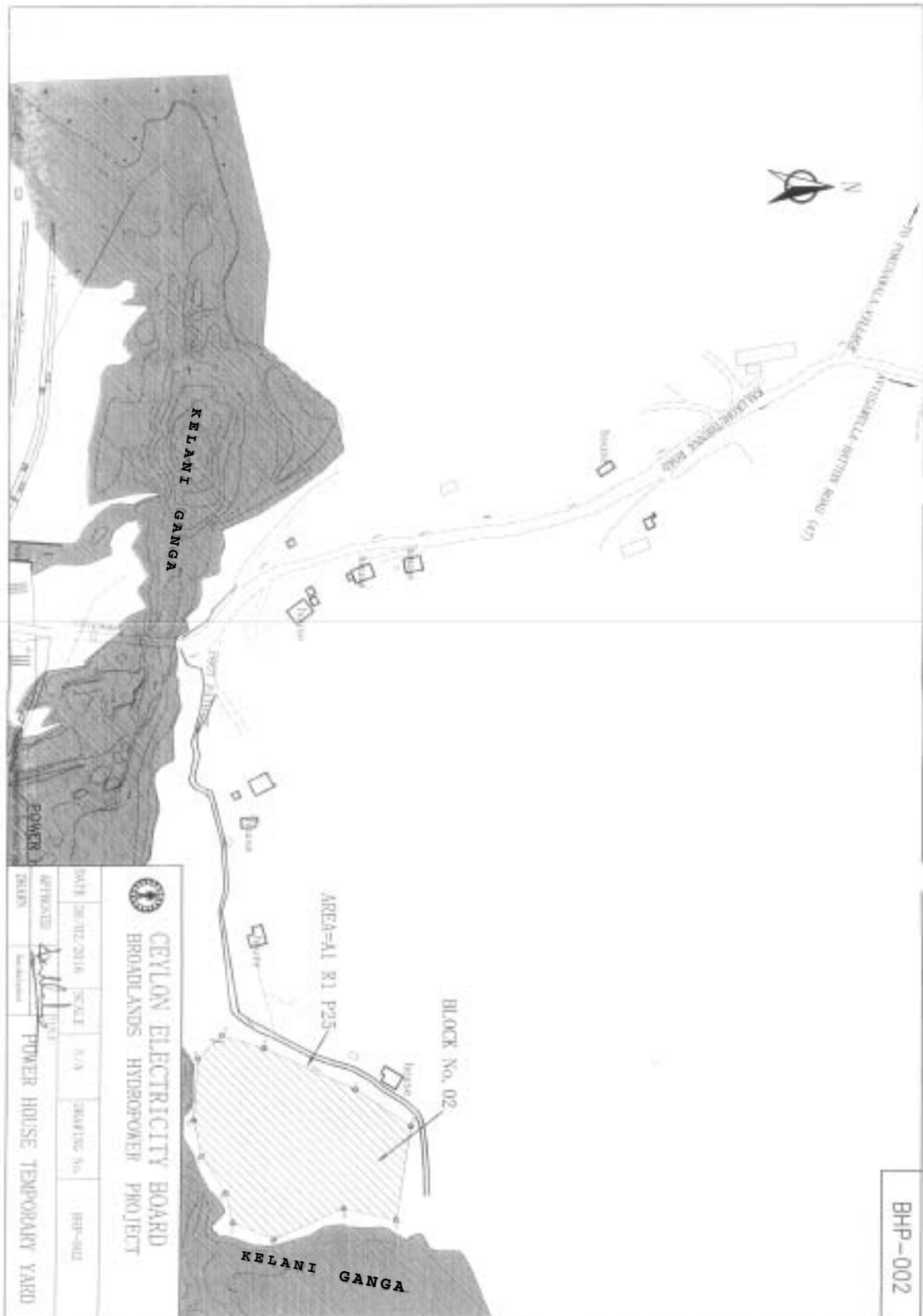

BHP-002